

# Clarifire®

## STRONG-ARM



### CHAIN BLOCKS

CCH1000C, CCH2000C, CCH3000C

PART NO: 7630463, 7630473, 7630483

## OPERATION & MAINTENANCE INSTRUCTIONS

UK  
CA | CE

ORIGINAL INSTRUCTIONS

GC12/22

---

## INTRODUCTION

---

Thank you for purchasing this CLARKE Chain Block assembly.

Before attempting to use this product, please read this manual thoroughly and follow the instructions carefully. In doing so you will ensure the safety of yourself and that of others around you, and you can look forward to your purchase giving you long and satisfactory service.

---

## INTENDED USE

---

The chain block assembly is a portable lifting device easily operated by the hand chain. It is suitable for use in factories, garages, farms, construction sites, docks and warehouses for installation of equipment, as well as for loading and unloading goods. It is specially advantageous for lifting work in open air grounds and places where no power supply is available.

The chain block can be attached to a trolley of any type as a travelling chain block. It is suitable for use with a monorail overhead conveying system, hand travelling crane and jib crane.

---

## SPECIFICATIONS

---

|                         | <b>CCH1000C</b> | <b>CCH2000C</b> | <b>CCH3000C</b> |
|-------------------------|-----------------|-----------------|-----------------|
| Part Nos.               | 7630463         | 7630473         | 7630483         |
| Capacity (tonnes)       | 1               | 2               | 3               |
| Maximum Lift (mm)       | 3000            | 3000            | 3000            |
| Min overall height (mm) | 320             | 400             | 500             |
| Max overall height (mm) | 3200            | 3200            | 3200            |

---

## GUARANTEE

---

This product is guaranteed against faulty manufacture for a period of 12 months from the date of purchase. Please keep your receipt which will be required as proof of purchase.

This guarantee is invalid if the product is found to have been abused or tampered with in any way, or not used for the purpose for which it was intended.

Faulty goods should be returned to their place of purchase, no product can be returned to us without prior permission. This guarantee does not effect your statutory rights.

---

## **SAFETY PRECAUTIONS**

---

### **ALWAYS:**

1. Inspect the general condition of the chain block and chains for signs of damage or wear before placing into storage.
2. Check that the load hook will reach its lowest point without running the chain fully out.
3. Ensure that the suspension point is strong enough to take the weight of the chain block and its load.
4. Check the travel path is clear and that you have a clear view to avoid any obstructions.
5. Wear industrial gloves when operating the chain block.
6. Wear a hard hat, safety shoes and safety goggles when operating the chain block.

### **NEVER:**

1. Lift a load exceeding the rated capacity stated on the chain block.
2. Use the chain block when the chain is kinked.
3. Stand beneath a raised load.
4. Use the chain block if it requires more than ordinary effort to operate it.
5. Throw, drop or drag the chain block.
6. Use undue effort to force the block to operate.
7. Allow oil or grease to come into contact with the brake.
8. Lift loads at an angle or use for towing. Only lift loads vertically.
9. Never replace the load chain with a non-approved chain.

### **BEFORE LIFTING**

1. Careful inspection should be made to the parts such as hook, load chain, braking device, etc. and the lubrication of the block. The chain block can only be put into operation when it is found to be in good condition.
2. Judge the weight of the load to be lifted and make sure the chain block is suitably rated. Never overload the block.
3. Attach the chain block to the suspension point.
  - The suspension point must be able to support the weight of the load and the chain block.
4. Attach the load hook directly to the load or sling, ensuring it is directly above the centre of gravity of the load.

---

## OPERATION

---

1. Ensure that no obstruction prevents a clean lift
2. Gently raise or lower the load by pulling the hand chain through the block in the desired direction - Clockwise to lift and anti-clockwise to lower
  - While lifting or lowering a load, the hand chain should be pulled steadily to prevent it from jerking or tangling.
  - Lift the load a few centimeters and check stability before commencing full lift.
  - DO NOT allow anyone to walk or work under a lifting load.
  - When lowering a load, be aware that when the hand chain is released, the load will not stop immediately but may continue for a few more millimeters as the brake takes effect.

**NOTE:** The brake may get hot with continued use.

3. After operation, clean the chain block and lubricate the chain if required. Store it in a dry place to protect it from rust and corrosion.

## JAMMING

Stop operation immediately if the hand chain cannot be pulled any further. Don't try to force the chain.

Proceed inspection as follows:

- a. If there is anything entangled with the load.
- b. Whether there is any trouble with the parts of the block.
- c. Whether the load weight is over the rated capacity of the block.

---

## MAINTENANCE

---

### EVERY SIX MONTHS

1. Fully unwind the lifting chain and check its general condition for corrosion, wear and signs of stretching or fracture.
2. Lubricate the chain and moving parts to inhibit corrosion.
3. Check the security and condition of the suspension point.
4. Check the condition of hooks and the tightness of all bolts and screws.

**NOTE:** When in constant use, the chain block should be inspected more frequently. If in doubt about the use or maintenance of this equipment, consult your local authorised CLARKE dealer.

# COMPONENT PARTS

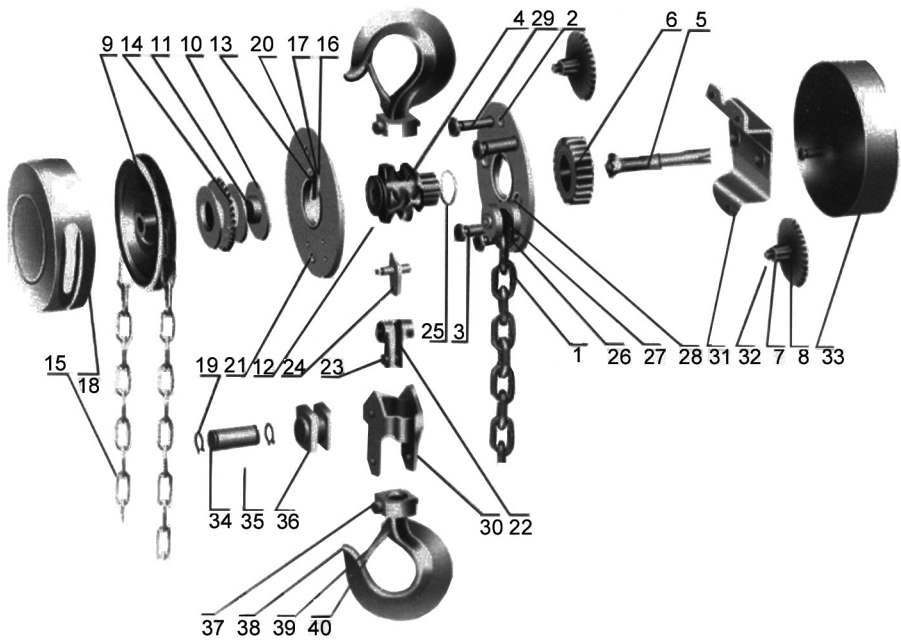

|                   |                     |                      |                       |
|-------------------|---------------------|----------------------|-----------------------|
| 1. Load chain     | 11. Friction plate  | 21. LH Sideplate     | 31. Bent plate        |
| 2. RH Sideplate   | 12. Roller          | 22. Suspension plate | 32. Roller            |
| 3. Stripper A     | 13. Bearing race    | 23. Suspension Pin   | 33. Sheet cover       |
| 4. Chain sprocket | 14. Ratchet disc    | 24. Orifice plate    | 34. Idle sheave shaft |
| 5. Driving shaft  | 15. Hand chain      | 25. Circlip          | 35. Headless rivet    |
| 6. Splined gear   | 16. Pawl spring     | 26. Left side plate  | 36. Idler sheave      |
| 7. Pinion shaft   | 17. Pawl            | 27. Guide roller     | 37. Hook holder       |
| 8. Disc Gear      | 18. Handwheel cover | 28. Suspension pin   | 38. Pivot Pin         |
| 9. Handwheel      | 19. Circlip         | 29. Stay B           | 39. Latch             |
| 10. Brake seat    | 20. Pawl pin        | 30. Snap ring        | 40. Double spring     |

# DECLARATION OF CONFORMITY - UK

**UK  
CA**

**Clarke<sup>®</sup>**  
**INTERNATIONAL**

Hemnall Street, Epping, Essex CM16 4LG

## DECLARATION OF CONFORMITY

**This is an important document and should be retained.**

**We hereby declare that this product(s) complies with the following statutory requirement(s):**

*Supply of Machinery (Safety) Regulations 2008*

**The following standards have been applied to the product(s):**

*EN 13157:2004+A1*

The technical documentation required to demonstrate that the product(s) meet(s) the requirement(s) of the aforementioned legislation has been compiled and is available for inspection by the relevant enforcement authorities.

**The UKCA mark was first applied in: 2022**

**Product Description:** 1000kg, 2000kg & 3000kg Chain Hoists  
**Model number(s):** CCH1000C, CCH2000C & CCH3000C  
**Serial / batch Number:** N/A  
**Date of Issue:** 20/12/2022

**Signed:**

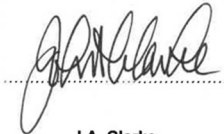

**J.A. Clarke**  
**Director**

# DECLARATION OF CONFORMITY - CE



**Clarke**<sup>®</sup>  
**INTERNATIONAL**

Fitzwilliam Hall, Fitzwilliam Place, Dublin 2

## DECLARATION OF CONFORMITY

**This is an important document and should be retained.**

**We hereby declare that this product(s) complies with the following directive(s):**

*2006/42/EC Machinery Directive*

**The following standards have been applied to the product(s):**

*EN 13157:2004+A1*

The technical documentation required to demonstrate that the product(s) meet(s) the requirement(s) of the aforementioned directive(s) has been compiled and is available for inspection by the relevant enforcement authorities.

**The CE mark was first applied in: 2022**

**Product Description:** 1000kg, 2000kg & 3000kg Chain Hoists  
**Model number(s):** CCH1000C, CCH2000C & CCH3000C  
**Serial / batch Number:** N/A  
**Date of Issue:** 20/12/2022

**Signed:**

**J.A. Clarke**  
**Director**

# A SELECTION FROM THE VAST RANGE OF

# Clarke®

## QUALITY PRODUCTS



### AIR COMPRESSORS

From DIY to industrial, Plus air tools, spray guns and accessories.

### GENERATORS

Prime duty or emergency standby for business, home and leisure.

### POWER WASHERS

Hot and cold, electric and engine driven - we have what you need

### WELDERS

Mig, Arc, Tig and Spot. From DIY to auto/industrial.

### METALWORKING

Drills, grinders and saws for DIY and professional use.

### WOODWORKING

Saws, sanders, lathes, mortisers and dust extraction.

### HYDRAULICS

Cranes, body repair kits, transmission jacks for all types of workshop use.

### WATER PUMPS

Submersible, electric and engine driven for DIY, agriculture and industry.

### POWER TOOLS

Angle grinders, cordless drill sets, saws and sanders.

### STARTERS/CHARGERS

All sizes for car and commercial use.

## PARTS & SERVICE:

## 0208 988 7400

### Parts Enquiries

[Parts@clarkeinternational.com](mailto:Parts@clarkeinternational.com)

### Servicing & Technical Enquiries

[Service@clarkeinternational.com](mailto:Service@clarkeinternational.com)

SALES: UK 01992 565333 or Export 00 44 (0)1992 565335

**Clarke** INTERNATIONAL Hemnall Street, Epping, Essex CM16 4LG  
[www.clarkeinternational.com](http://www.clarkeinternational.com)