

Champro®



DRILL STAND WITH VICE

Model No: CDS3

Part No: 6500224

ASSEMBLY INSTRUCTIONS

GC09/13

INTRODUCTION

Thank you for purchasing this CLARKE product.

Please read and follow the instructions carefully. In doing so you will ensure the safety of yourself and others around you, and you can look forward to the product giving you long and satisfactory service.

Please keep these instructions in a safe place for future reference

GUARANTEE

This product is guaranteed against faulty manufacture for a period of 12 months from the date of purchase. Please keep your receipt which will be required as proof of purchase.

This guarantee is invalid if the product is found to have been abused or tampered with in any way, or not used for its intended purpose. Faulty goods should be returned to their place of purchase. No product can be returned to us without prior permission.

This guarantee does not effect your statutory rights.

SPECIFICATION

Feature	Dimension
Maximum Drilling Depth	60 mm
Column Height	500 mm
Weight	3.38 kg
Dimensions (D x W x H)	352 x 160 x 498 mm
Drill Collar Sizes	38 / 43 mm

COMPONENT PARTS

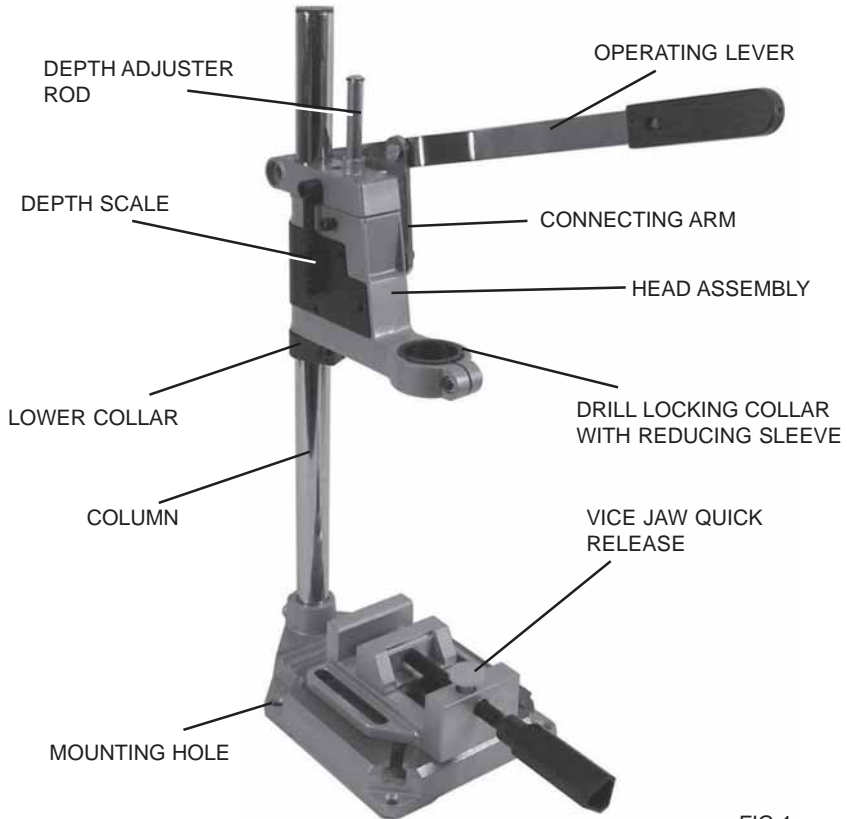

FIG 1

The component parts of your CDS3 drill stand are shown in fig 1.

- Any electric drill with a standard 43mm diameter neck may be fitted directly to the head assembly.
- A reducing sleeve is provided, allowing a drill with a 38mm diameter neck also to be accommodated.
- The depth of travel of the drill may be controlled by using the depth adjuster. A depth scale is provided so that accurate drilling depths may be set.

ASSEMBLY

1. Insert the column into the base and secure with the bolt using a 14mm wrench.
 - Ensure the column does not project below the base.
2. Slide the lower collar onto the column and secure approximately half way up the column using the hex key.

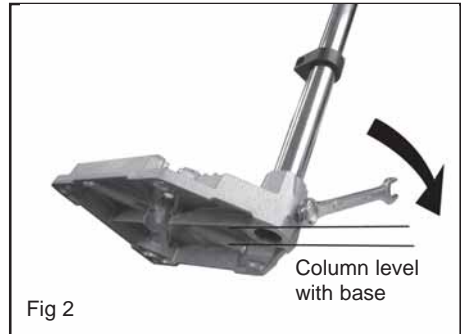

3. Slide the head assembly onto the column.
4. Attach the operating lever to both the head assembly and to the connecting arm using the nut/bolt at one end, using a 10mm wrench and tighten the hex key loosely at the other end.

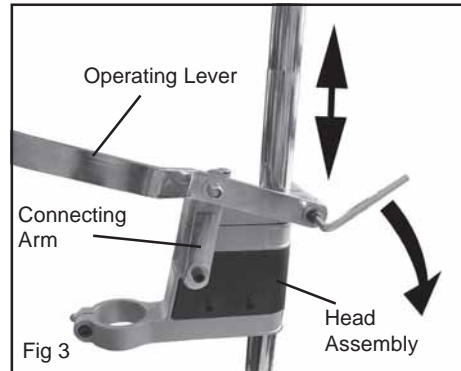

5. Always store the hex key in the clips on the side of the head assembly.



6. Secure the vice to the base using two suitable bolts with nuts and washers (not supplied).
 - To position the vice relative to the column, slacken the two vice securing bolts and manoeuvre the vice as required.

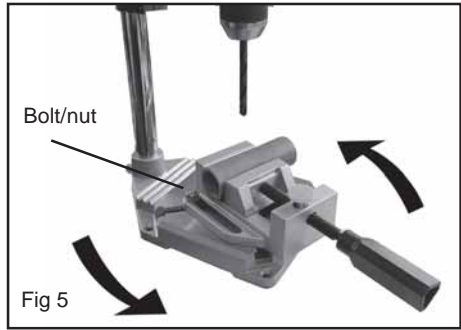

IMPORTANT!

Secure the base to a workbench or sturdy table using suitable bolts (not supplied). Drill the work-bench/table accordingly, using the four mounting holes in the stand base as a template.

FITTING A DRILL

1. Fit an electric drill with a standard 43mm diameter neck to the head assembly and secure in the locking collar as shown in Fig 6. Tighten the locking collar using the hex key.
2. If using a drill with a 38mm neck, fit the reducing sleeve provided into the locking collar before inserting the drill.



SETTING THE DEPTH

1. Decide on the depth of hole required to be drilled.
2. Release the hex head bolt which locks the depth adjusting rod.
3. Using the operating arm, lower the drill until the required reading is showing on the scale and lock the depth adjuster rod at this position using the hex key.
4. It is recommended that a light smearing of lubricant be applied to the column to assist with free movement.

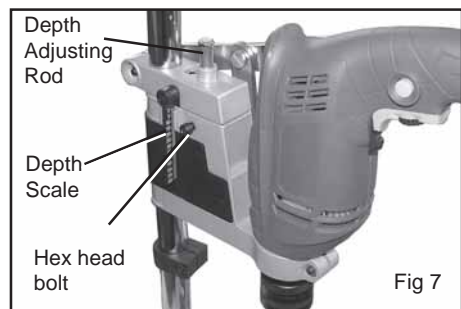

DRILLING THE HOLE

1. Lower the head assembly until the drill bit is just touching the workpiece as in Fig 8, and set the head assembly in position using the hex key shown in Fig 3.
2. Switch the drill on, and press down on the operating lever as the drill bit starts drilling. The depth of hole will be restricted by the depth stop.



ADJUSTING THE VICE

1. A quick setting button is provided for the vice jaw adjustment. Press the red button whilst pushing IN or pulling OUT the handle.

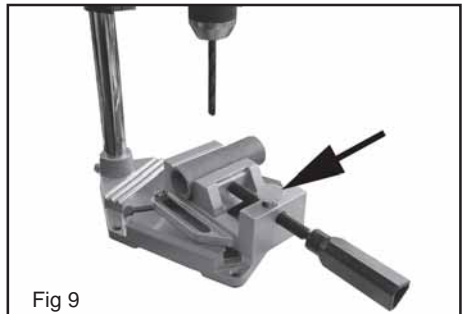

A SELECTION FROM THE VAST RANGE OF

Clarke®

QUALITY PRODUCTS

AIR COMPRESSORS

From DIY to industrial, Plus air tools, spray guns and accessories.

GENERATORS

Prime duty or emergency standby for business, home and leisure.

POWER WASHERS

Hot and cold, electric and engine driven - we have what you need

WELDERS

Mig, Arc, Tig and Spot. From DIY to auto/industrial.

METALWORKING

Drills, grinders and saws for DIY and professional use.

WOODWORKING

Saws, sanders, lathes, mortisers and dust extraction.

HYDRAULICS

Cranes, body repair kits, transmission jacks for all types of workshop use.

WATER PUMPS

Submersible, electric and engine driven for DIY, agriculture and industry.

POWER TOOLS

Angle grinders, cordless drill sets, saws and sanders.

STARTERS/CHARGERS

All sizes for car and commercial use.



PARTS & SERVICE: 020 8988 7400

E-mail: Parts@clarkeinternational.com or Service@clarkeinternational.com

SALES: UK 01992 565333 or Export 00 44 (0)1992 565335

Clarke INTERNATIONAL Hemnall Street, Epping, Essex CM16 4LG
www.clarkeinternational.com